

SPECIFICATION SHEET

INSTALLATION
IN THE BOX

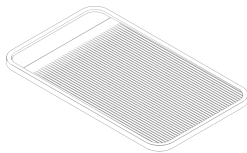

1. Shower Tray

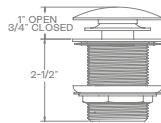

2. Drain Kit (BDWOF-ST-NS)
EZ-CLICK™ Bath tub
Drain without overflow
(Drain tube not included)



3. Manual

SHOWER TRAY PLACEMENT

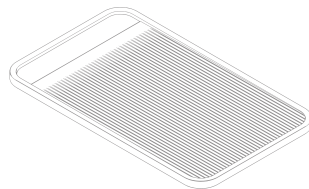
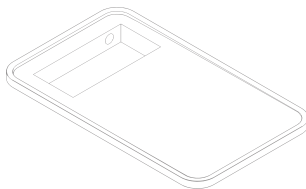

DRAIN KIT PLACEMENT

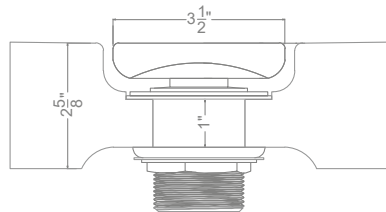
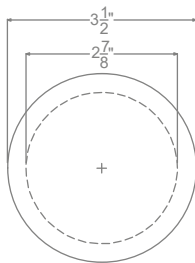

Drain Cap Closed Detail

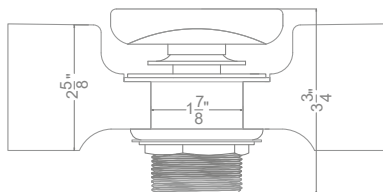

Drain Cap Opened Detail

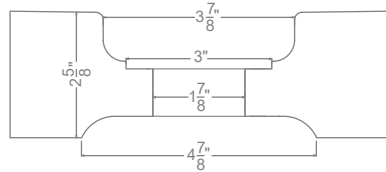

+1 (310) 341-6931

+1 (323) 538-3630

WWW. BORROWEDEARTHCOLLABORATIVE.COM

INFO@ BORROWEDEARTHCOLLABORATIVE.COM

INSTALLATION

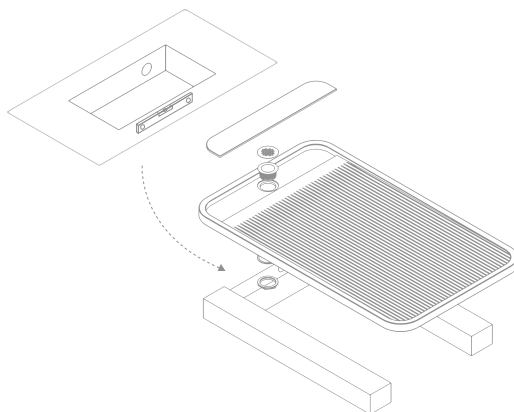
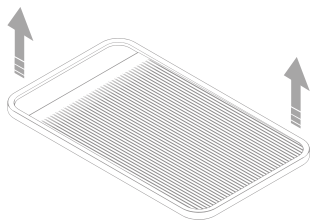

1. Pick the shower tray using mechanical lift or with the help of professionals.

2. Check level of the mortar base, and place the shower tray on top of the wooden spacers.

INSTALLATION FOR PLUMBER

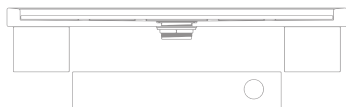

1. Place the Drain Kit and waste pipe under the shower tray and remove the wooden spacer

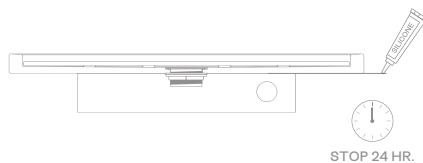

2. Place the tray and apply the silicone on the borders and wait 24. Hours.

WARNING: PULL THE TUB USING PROFESSIONAL OR MECHANICAL LIFTING EQUIPMENT.

borrowed earth

Borrowed Earth celebrates our inviolable connection to nature and attempts to recreate the innate joy of cohabiting amidst it.



+1 (310) 341-6931

+1 (323) 538-3630

WWW. BORROWEDEARTHCOLLABORATIVE.COM

INFO@ BORROWEDEARTHCOLLABORATIVE.COM